

## Beginning ...

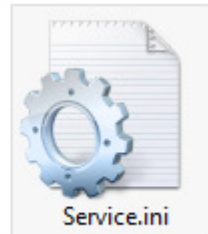

## Make an ID & Type the ID into the Service.ini

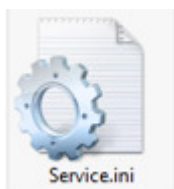

Open Service.ini file



```
File Edit Format View Help
[HTTP]
Address=http://cloud.posbankusa.com/report/item/
[Customer]
ID=YYYYMMDD001
[Setting]
Interval(Sec)=600
[ItemCount]
TopSalesItemCount=10
```

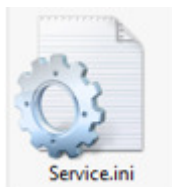

Save Service.ini file

Ex. 20160301001

# Copy & Paste Files

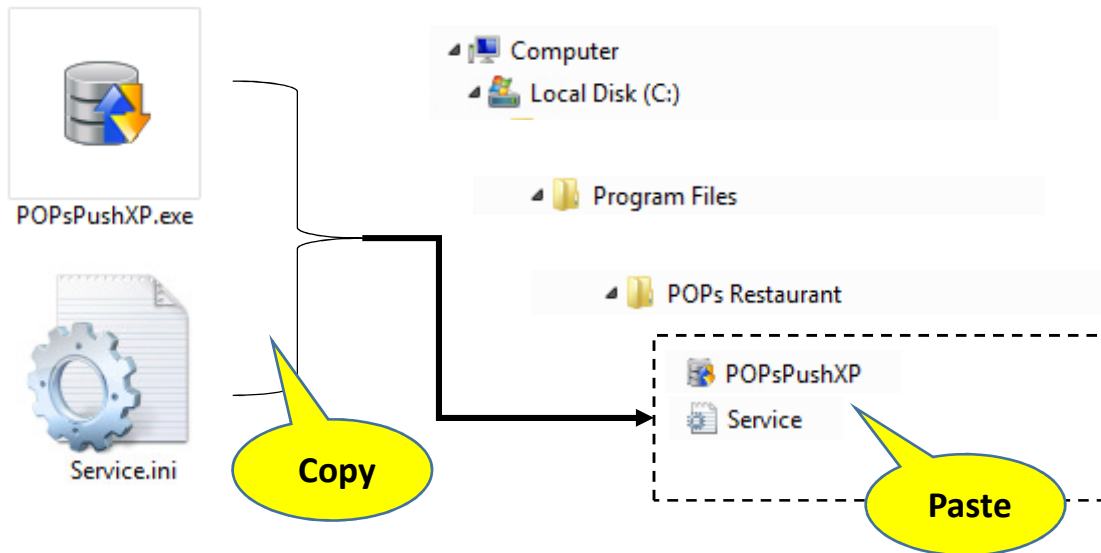

# Create shortcut

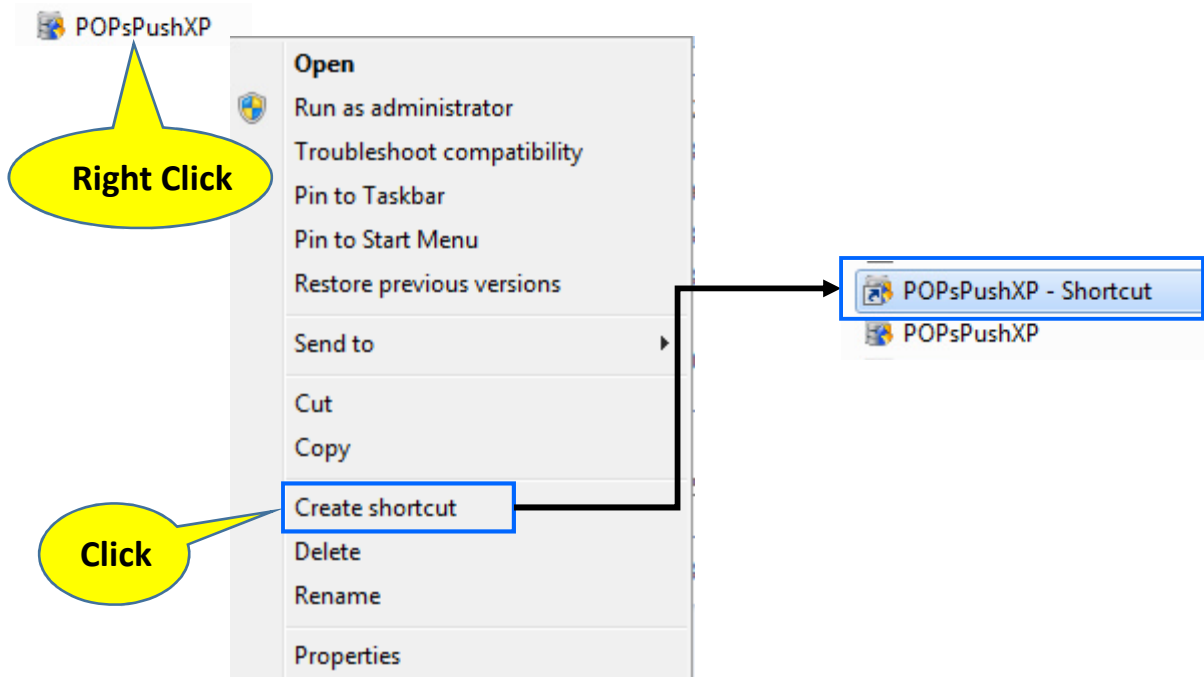

# Shortcut File Copy & Paste

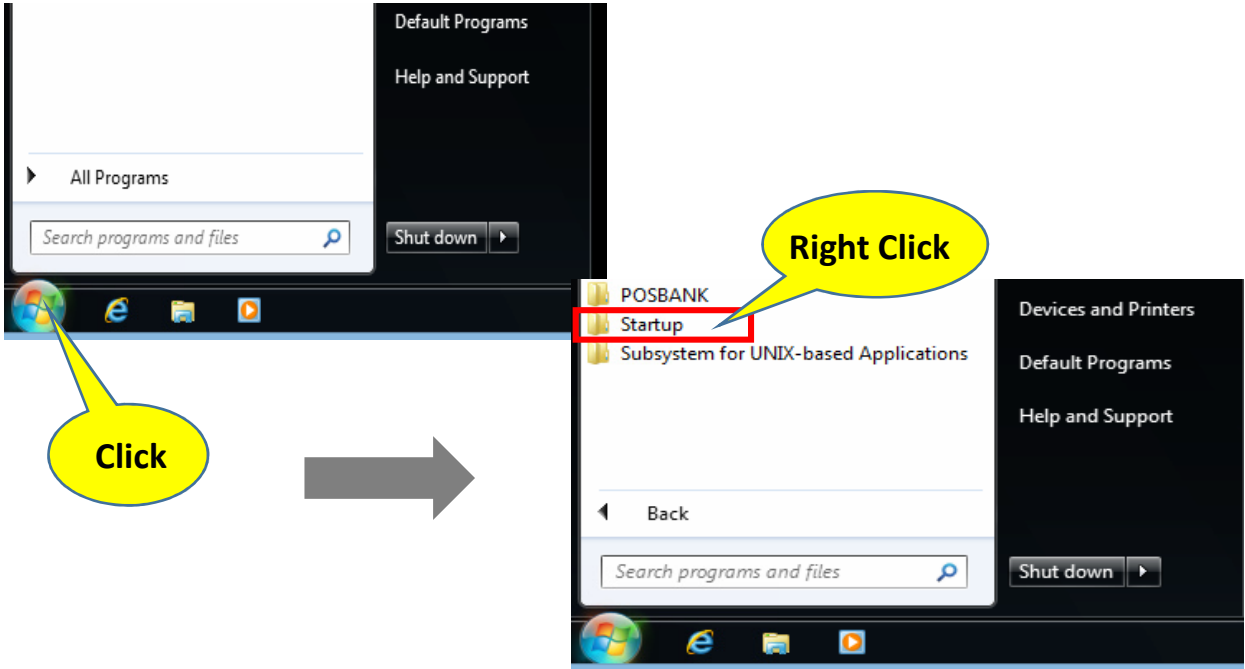

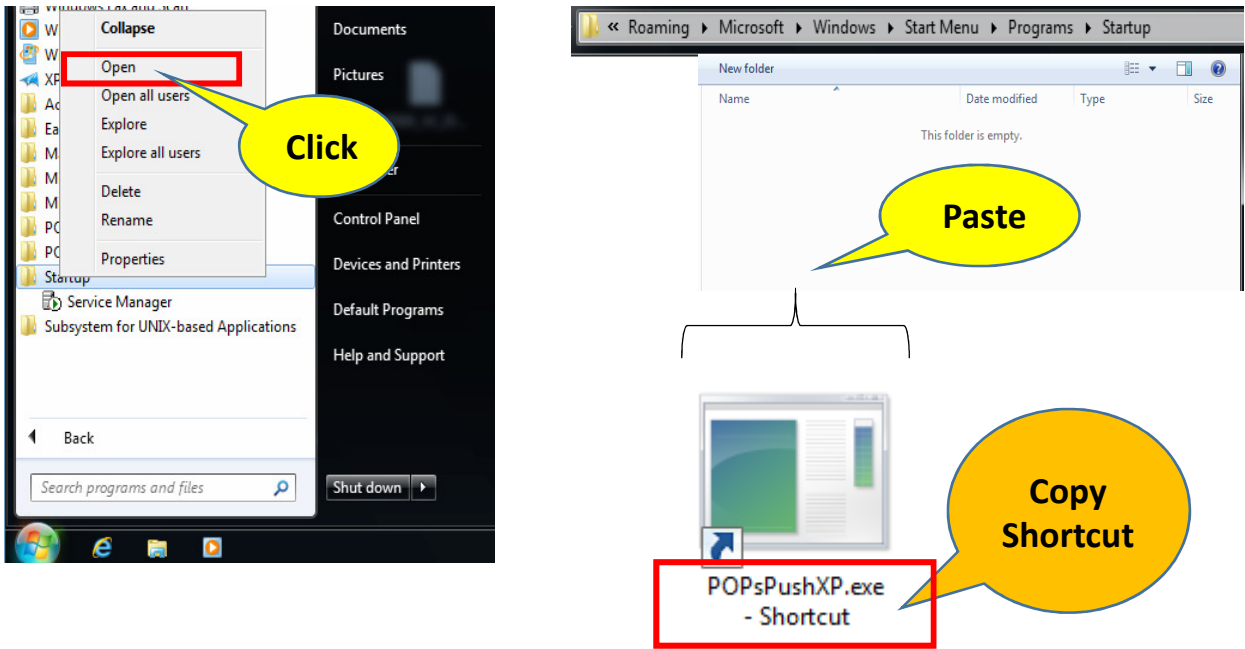

# Copy & Paste Files

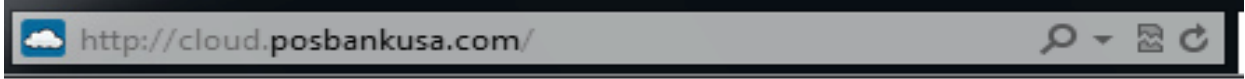

finish

# Login ...



  
 Sign in to PBUS Cloud

Password

[Need help?](#)

ID

Password

# Sales Report

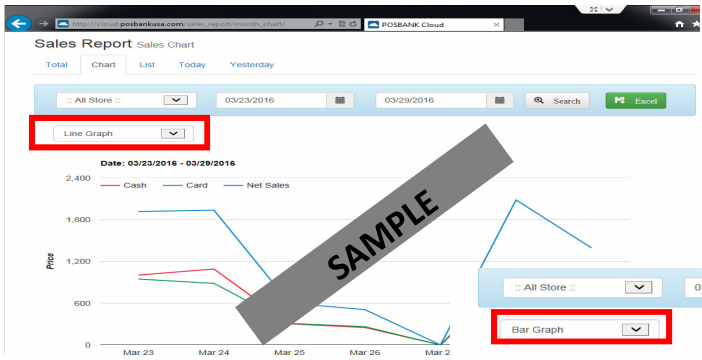

# Sales Item Report

POS BANK USA Cloud

Sales Report

Item Report

Log Out

## Top Sales Item Report Analysis Chart

Teh Cafe - USC 2

QTY Sort

03/24/2016

03/30/2016

Search

3D Pie Chart

Date: 03/24/2016 - 03/30/2016

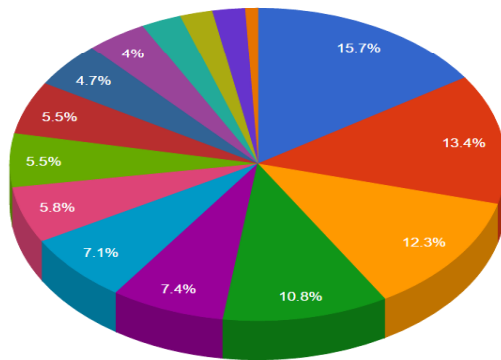

- 1. COFFEE OF THE DAY (T) (8.47%)
- 2. OPEN PRICE (7.21%)
- 3. COFFEE OF THE DAY (G) (6.64%)
- 4. FEE (5.80%)
- 5. CAN (4.01%)
- 6. PASTRY (3.82%)
- 7. SANDWICH (3.13%)
- 8. BAGEL CREAM CHEESE (2.98%)
- 9. BANANA (2.94%)
- 10. WATER (2.56%)
- 11. CHIP (2.14%)
- 12. STRAWBERRY (1.41%)
- 13. STRAWBERRY & FRUIT (1.14%)
- 14. Palmier (1.14%)
- 15. HOT CHOCOLATE (T) (0.46%)